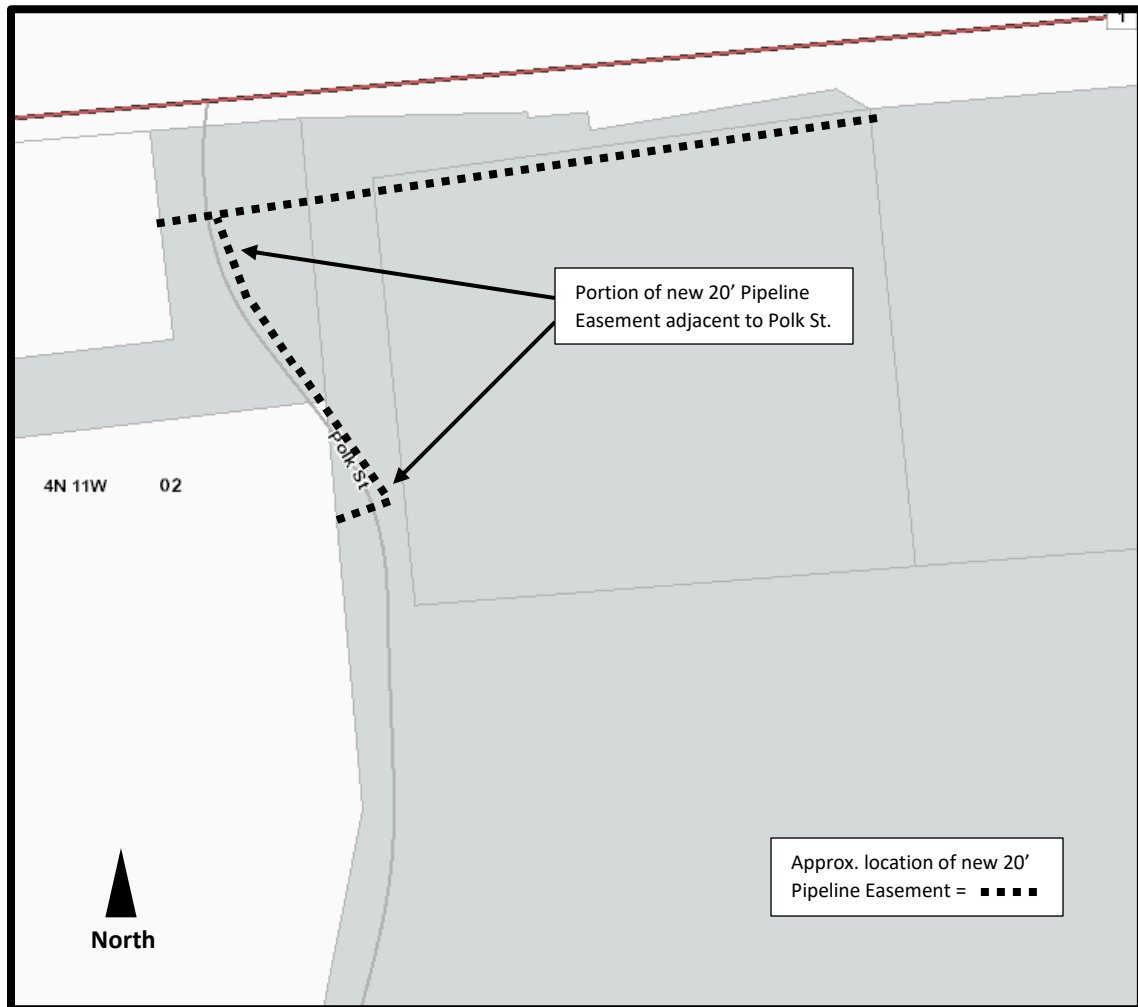

Exhibit "A"

The following is made a part of that certain Pipeline Easement, dated _____ by and between Anaconda-Deer Lodge County, Montana as "Grantor" and Northwestern Corporation D/B/A NorthWestern Energy as "Grantee".

All distances, areas and measurements shown below are approximate and not to scale.



A portion of Tract 1-A and Tract 1-E of the East Yards Frontage Minor Subdivision Plat, recorded on Certificate of Survey 456-A, and a portion of Mitchell Road of Certificate of Survey No. 298-A, located in the SE4 of Section 2, Township 4 North, Range 11 West, P.M.M., Anaconda-Deer Lodge County, Anaconda, Montana, according to the official plat thereof on file and or record in the office of the Clerk and Recorder of Anaconda-Deer Lodge County, Montana.